



Bird's Eye View



Exterior Computer Rendering

The Transportation Center addition / modernization project included an addition to lengthen the 6 maintenance bays for larger busses, the addition of a storage bay, and an addition for administrative staff. Modernization included new interior and exterior systems, a new metal roof, as well as M&E systems upgrades. The site was also improved to include more bus parking, provisions for heaters, a new fueling area, and a bus wash system.



Street View

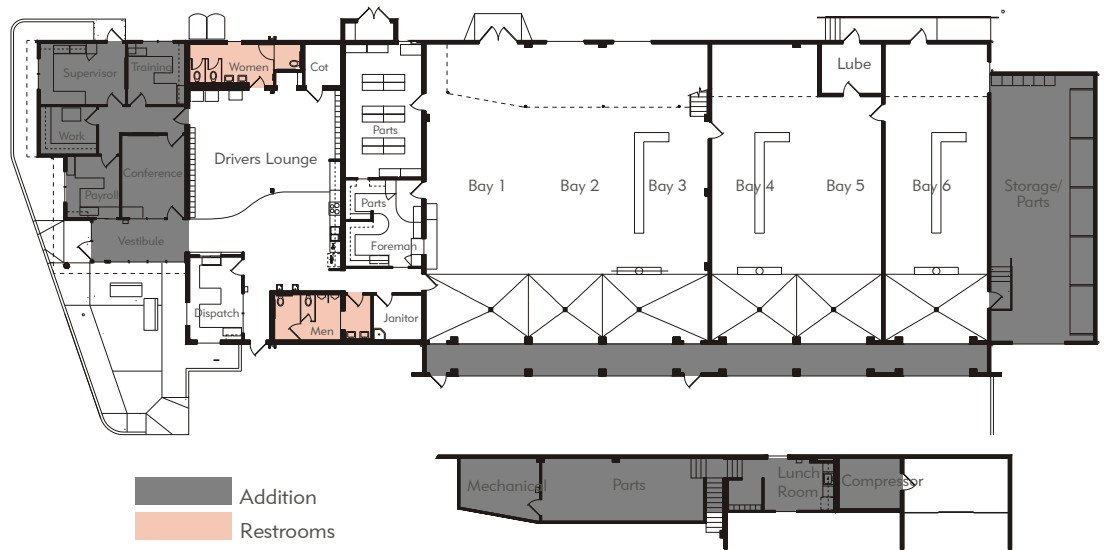

Main Floor Plan

Mezzanine Floor Plan

