



Exterior View at Main Entrance



Interior View at Foyer



Exterior View at Sanctuary

This is a seeker-sensitive church inspired by contemporary outreach-oriented ministries. The building is designed to be warm and inviting and to look like a community center that will attract people new to the church.

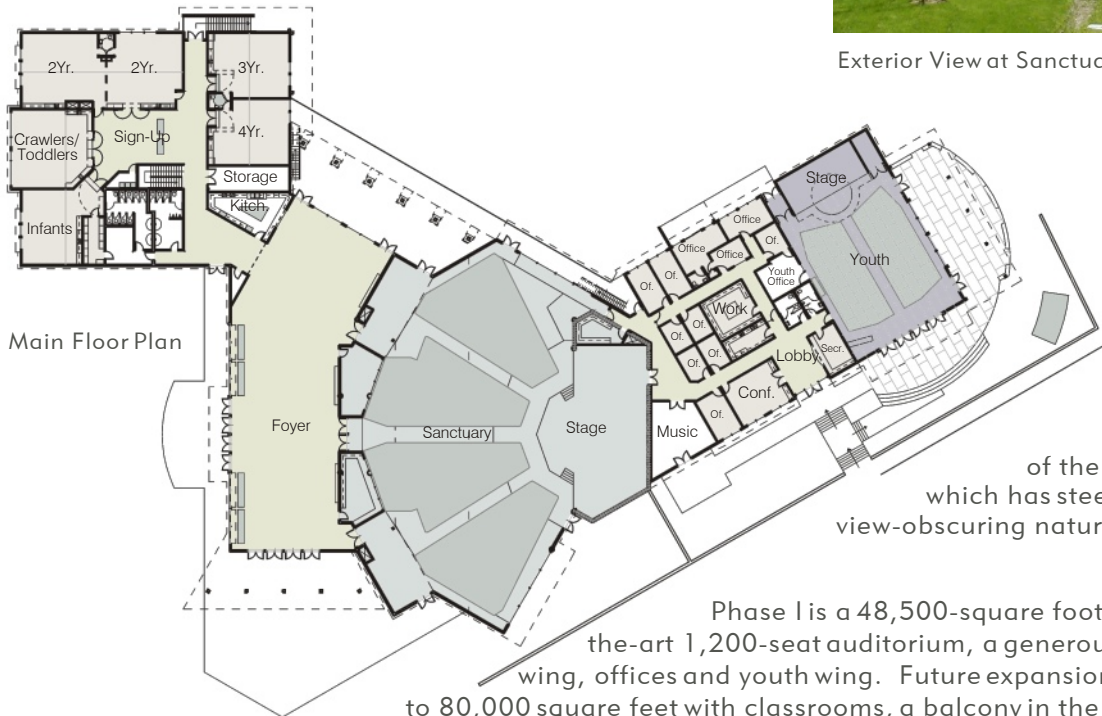

The project develops 19 of the heavily wooded 63-acre site which has steep slopes, wetlands, streams, view-obscuring natural buffers and even a hawk's nest to contend with.

Phase I is a 48,500-square foot building housing a state-of-the-art 1,200-seat auditorium, a generous foyer, two-story classroom wing, offices and youth wing. Future expansion will bring the building area to 80,000 square feet with classrooms, a balcony in the auditorium and the addition of a large fellowship hall.

